

POWER IS AVAILABLE SL AND SR.
 SL: 1 200 AMP PER LEG 3 PHASE LIGHTING SERVICE
 1 400 AMP PER LEG 3 PHASE LIGHTING SERVICE
 1 200 AMP PER LEG 3 PHASE ISOLATED GROUND SOUND SERVICE
 SR: 1 200 AMP PER LEG LIGHTING SERVICE
 1 400 AMP PER LEG LIGHTING SERVICE
 ALL COMPANY SWITCHES ARE CAM LOCK

DRESSING ROOMS:
 2 ENSEMBLE DRESSING ROOMS
 LOCATED BACK STAGE RIGHT.
 2 STAR DRESSING ROOMS (2
 PERSONS EACH) LOCATED BACK
 STAGE LEFT

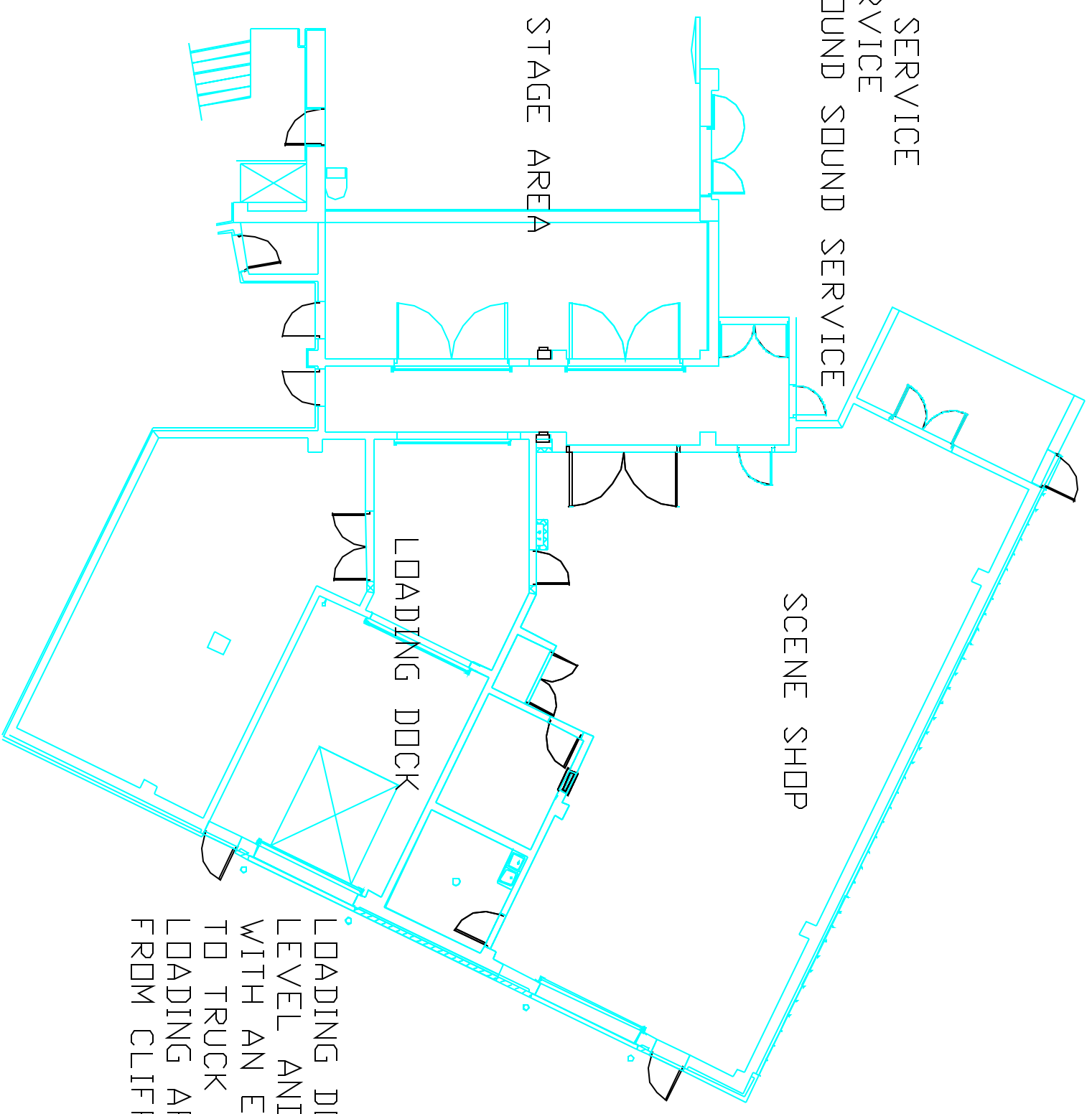

LOADING DOCK IS AT GROUND
 LEVEL AND IS EQUIPPED
 WITH AN ELEVATOR TO RISE
 TO TRUCK LEVEL
 LOADING AREA IS ACCESSIBLE
 FROM CLIFF DRIVE